

TRADE SITE

APPLICATION FORM

OUTSIDE FOOD & TRADE SITES

For Murray Bridge 101st Annual Show
 To be held Saturday, 28 September 2019 from 9 am – 9 pm AND
 Sunday 29 September 2019 9 am – 4 pm INCLUSIVE

The Murray Bridge Show has a large showground with extensive livestock and animal displays and exhibitions. Our map of the showgrounds references each of the trade display areas so that trade exhibitors can select the best area for their displays.

Stall holders from the 2018 event will have the first opportunity to secure their trade positions. You will need to identify more than one preferred site however first preference will be given to stall holders wishing to remain in their 2018 spot.

The following graphics highlight the trade areas that we have established. If you have specific needs that are not met by the defined sites then please do not hesitate to contact us at the show office.

Figure 1 Showground Map

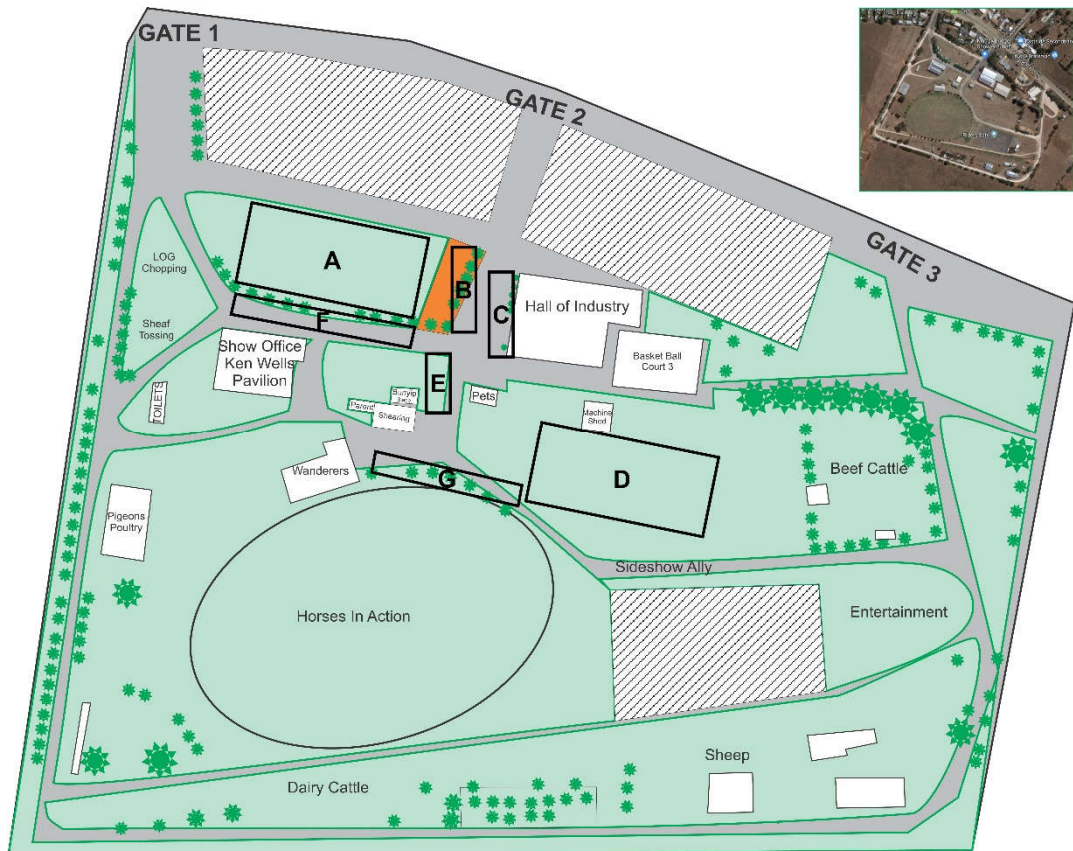

OFFICE USE ONLY				
Chq/MOrder	Receipt No:	Site Number:	Tickets:	Confirmed:

First preference will go to local vendors from the Rural City of Murray Bridge Council Area.

To avoid duplication, you are requested to list all of the items you will be selling.

The Murray Bridge Show retains the exclusive right to sell cans of soft drink should they choose to do so.

Should you attend the show and sell something that is not on your list you will be requested to remove that item from your stand. If you do not comply you will be asked to leave the premises and you will forfeit all money already paid.

The applications for food sites prices are set at the trade site value for this area. Everyone will be required to purchase site space for ALL equipment left on the show ground during show hours, for example if you have a marquis that measures 3mx3m and a coolroom that measures 3mx7m, you **MUST PURCHASE ENOUGH SITE SPACE FOR BOTH.**

You are required to purchase all power outlets that you require (including all power requirements for cool-rooms). This is to ensure we have sufficient power available for your requirements.

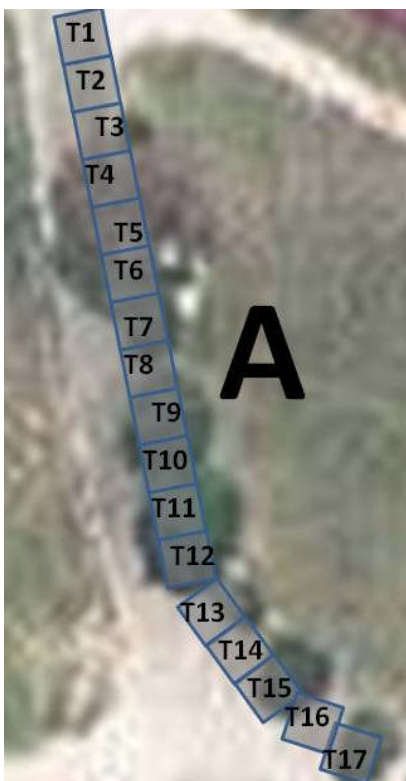

Trade area A is the closest trade area to Gate 1 and the free public car parking area. It leads most attendees of our show into the grounds.

Trade Area B hosts the Entertainment Stage and Entertainment areas.

Trade Areas C & D are the entry passage way for those coming in through gate 2 and also the welcoming area to the Hall of Industry, our wonderful undercover trade area.

Trade Area E is adjacent to the Bunyip stage where there are performances during the course of the Show weekend.

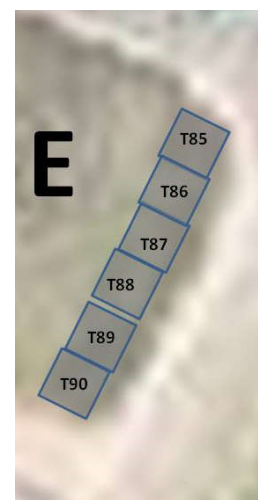
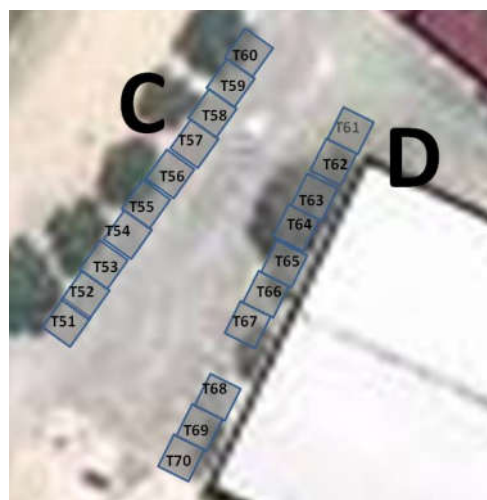

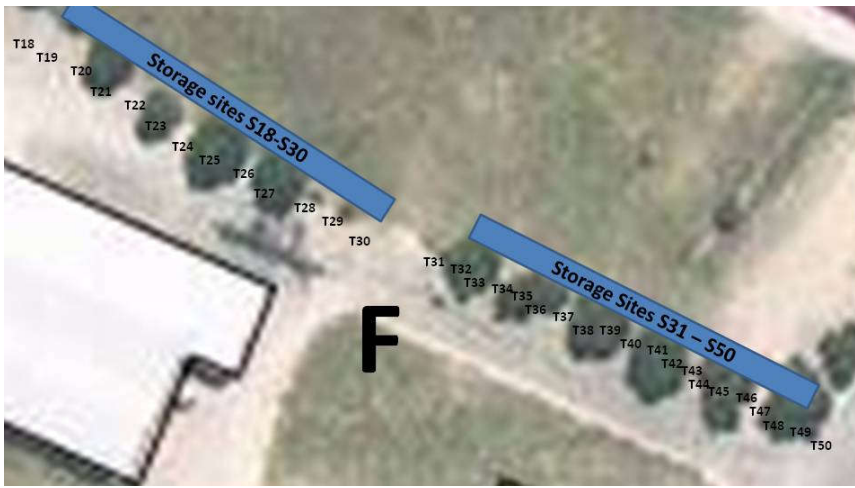

Our Trade Area F is our Food Zone and the trade sites along here are restricted to being food orientated businesses. This forms a wonderful Kaleidoscope of smells that entices our hungry crowd along.

Trade Area G is our major commercial trade zone and the area for our big impressive machinery and display items. This area has a wonderful



slope that provides fantastic opportunities for businesses to display their wares and the sites are huge at 10mx10m

Trade Area H has been introduced to serve the needs of our Horse exhibitors and other animal sections. This area forms a corridor for people going to and from our animal exhibits and is topped by the sounds and excitement of side show alley.



TRADE SITE APPLICATION – OUTSIDE TRADE SITES

MURRAY BRIDGE A&H SOCIETY INC.

PO Box 315, Murray Bridge SA 5253

Ph: (08) 8531 0248

Email: assistantsecretary@murraybridgeshow.com.au

ABN 11 686 674 167

BSB: 105-012 A/C No: 117824940

ALL TRADE SITE FEES MUST BE PAID IN FULL TWO WEEKS PRIOR TO THE DATE OF THE SHOW

FOOD

OUTSIDE TRADE

Trading Name _____				
Address _____				
			Post Code _____	
Contact Name _____				
Phone Number (____) _____		Mobile Number (____) _____		
Email _____				
Where you a trade site holder in 2018 Yes / No				
Site Preference	1 st Preference _____	2 nd Preference _____		
Area A (T1-T17)	3m x 3m site	\$75 incl GST per site	Qty _____	\$ _____
Area C (T51-T60)	3m x 3m site	\$75 incl GST per site	Qty _____	\$ _____
Area D (T61-T70)	3m x 3m site	\$75 incl GST per site	Qty _____	\$ _____
Premium Site Area E (T85 – T90)	3m x 3m site	\$150.00 incl GST per site	Qty _____	\$ _____
Food Zone Area F (T118-T50)	3m x 3m site	\$100 incl GST per site	Qty _____	\$ _____
Area G (T157-T165)	10m x 10m site	\$30 incl GST per site	Qty _____	\$ _____
Area H (T119-T150)	5m x 5m site	\$30 incl GST per site	Qty _____	\$ _____
NOT FOR PROFIT ORGANISATIONS	3m x 3m site	\$10 incl GST per Site	Qty _____	\$ _____
Trestles	2m x 800mm trestles @ \$20each for the weekend		Qty _____	\$ _____
Power	There are a limited number of sites that have access to power. If you need power please contact the office to determine the location of these power access sites. The cost of power is \$50 per power point outlet for the weekend.		Qty _____	\$ _____
Gate Passes	Each Trade Site will receive 4 Adult Show tickets. Additional tickets are available at a discounted price of \$8 per ticket per person and is valid for one entry only or you can purchase a 2-day pass for \$15.00.		Qty _____	\$ _____
Total Amount Payable				\$ _____
Do you require a Tax Invoice				Yes / No

Please list all goods to be sold on your site

TRADE SITE TERMS & CONDITIONS

PLEASE READ AND SIGN THESE TERMS AND CONDITIONS AS THEY MUST BE RETURNED WITH YOUR APPLICATION FORM

- 1. ALL TRADE SITE FEES MUST BE PAID IN FULL TWO WEEKS PRIOR TO THE DATE OF THE SHOW
2. Each trade booking will be provided with a single two day trade pass to enable entry into and out of the showground.
3. If using power, traders are to supply their own "Earth Leakage Circuit Breaker" and must have all electrical items tagged and compliant.
4. Carpet will be on the Hall of Industry floor prior to establishing your site.
5. Traders must have their own PUBLIC LIABILITY INSURANCE and a copy must be provided to the show office along with your trade site application.
6. FOOD VENDORS MUST COMPLY WITH ALL SOUTH AUSTRALIAN FOOD SAFETY LAWS.
7. FOOD VENDORS must submit a Temporary Food Stall Notification to the Council of the Rural City of Murray Bridge one week prior to the Show.
8. Vendors are only permitted to sell/display and/or exhibit products/goods as stated on their application and accepted and approved by the Murray Bridge Agricultural & Horticultural Society Inc.
9. The show strongly supports local accommodation providers in the region and recommends the camping facilities at all three local Caravan and Camping Parks.
10. All traders must fit within their site including trestles, tables and overhanging awning(s). THIS IS A TWO DAY SHOW and traders are expected to make a TWO DAY COMMITMENT to the event.
11. No refunds will be given for cancellation.
12. Trade stall holders are expected to have all vehicles off the grounds by

I _____ being the representative of _____
(Please print full name) (Company or trading name)

have read, understood and agree to the terms and conditions associated with having a trade display at the Annual Show of the Murray Bridge Agricultural & Horticultural Society Inc. I have provided a copy of our Public Liability Insurance Policy and accept that it will be used to service any claims associated with injury and incident that occurs at our trade stall and/or as a result of the product/service that we provide.

Signed

_____/_____/_____
Dated